

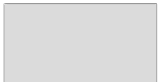





KEY:

Existing features:

-  Existing narrow footway
-  Existing pedestrian guardrailling

Proposed features:

-  Proposed pedestrian guardrailling
-  Proposed white edgeline (100mm wide)

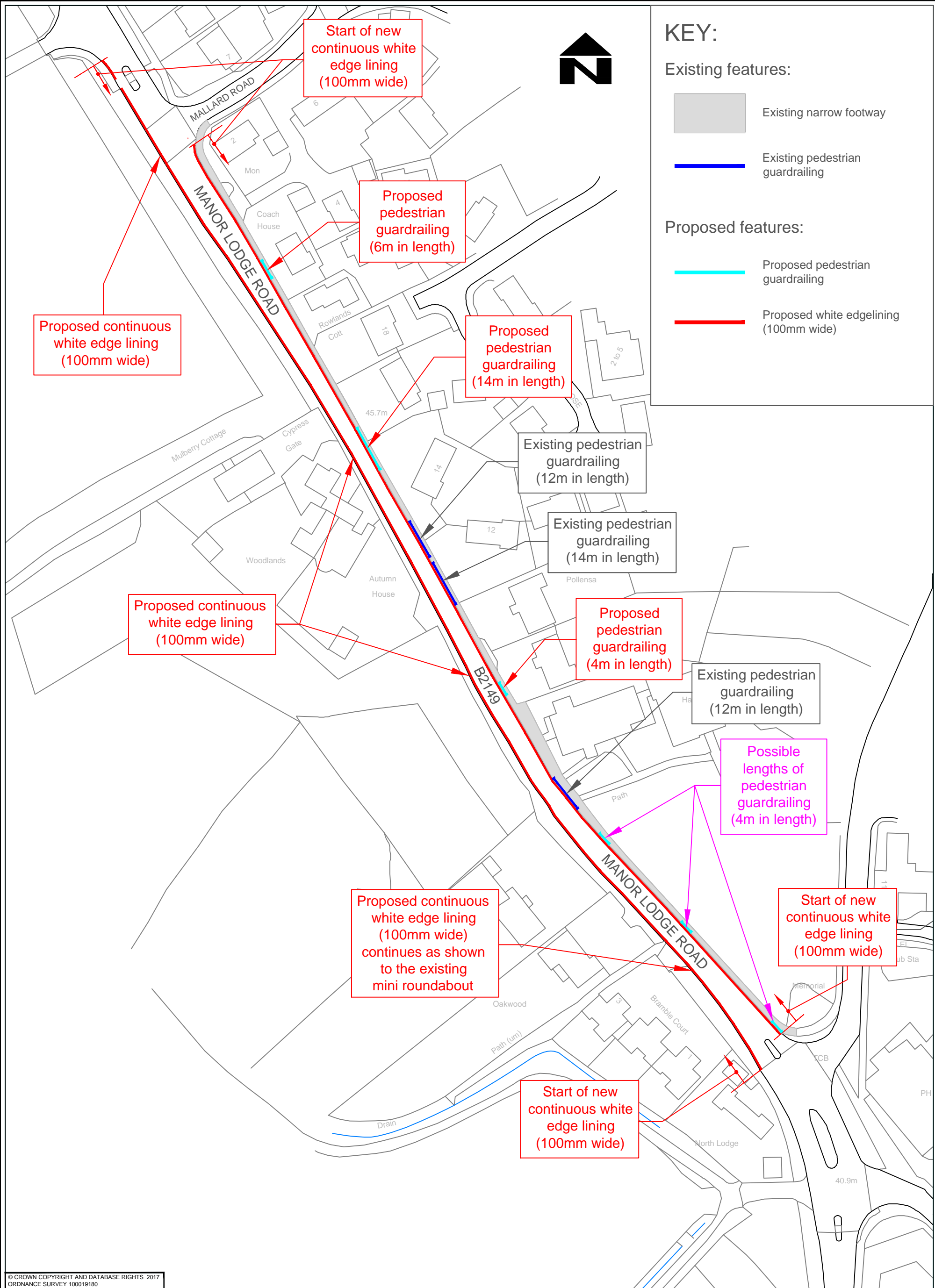

© CROWN COPYRIGHT AND DATABASE RIGHTS 2017
ORDNANCE SURVEY 100019180

REV	AMENDMENTS	DATE	CAD	CHKD	APPD

 **Hampshire**
County Council

STUART JARVIS BSc DipTP FCIHT MRTPI; DIRECTOR OF ECONOMY,
TRANSPORT & ENVIRONMENT

DESIGNER AM	SCHEME B2149 MANOR LODGE ROAD ROWLANDS CASTLE	DRAWING TITLE GUARDRAILING AND AND EDGELING PROPOSALS	
CAD AM		JOB No. SCALE @ A1	DATE 07/03/2018
CHECKED IJ	DATE 07/03/2018	SHEET NUMBER 1 OF 1	DRAWING NUMBER TM/RC/ MLR/AM/002
APPROVED IJ	SCALE @ A1 1:500	DATE 07/03/2018	SHEET NUMBER 1 OF 1

HCC CAD FILE: K:\Traffic Management Group\Lindsay-CAD\Drgs-Atstair\Rowlands Castle.dwg