

VILLAGE GATEWAY
DETAL

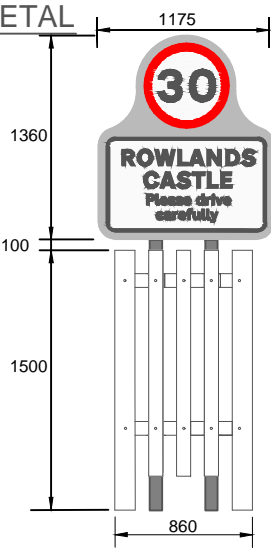

SIGNING KEY:

- Existing 30mph signs to be replaced**
- Existing 300mm diameter signs to remain
 - Proposed 300mm diameter signs mounted back to back

LINING KEY:

- Proposed roundel markings**
- Proposed elongated 30mph roundel road markings

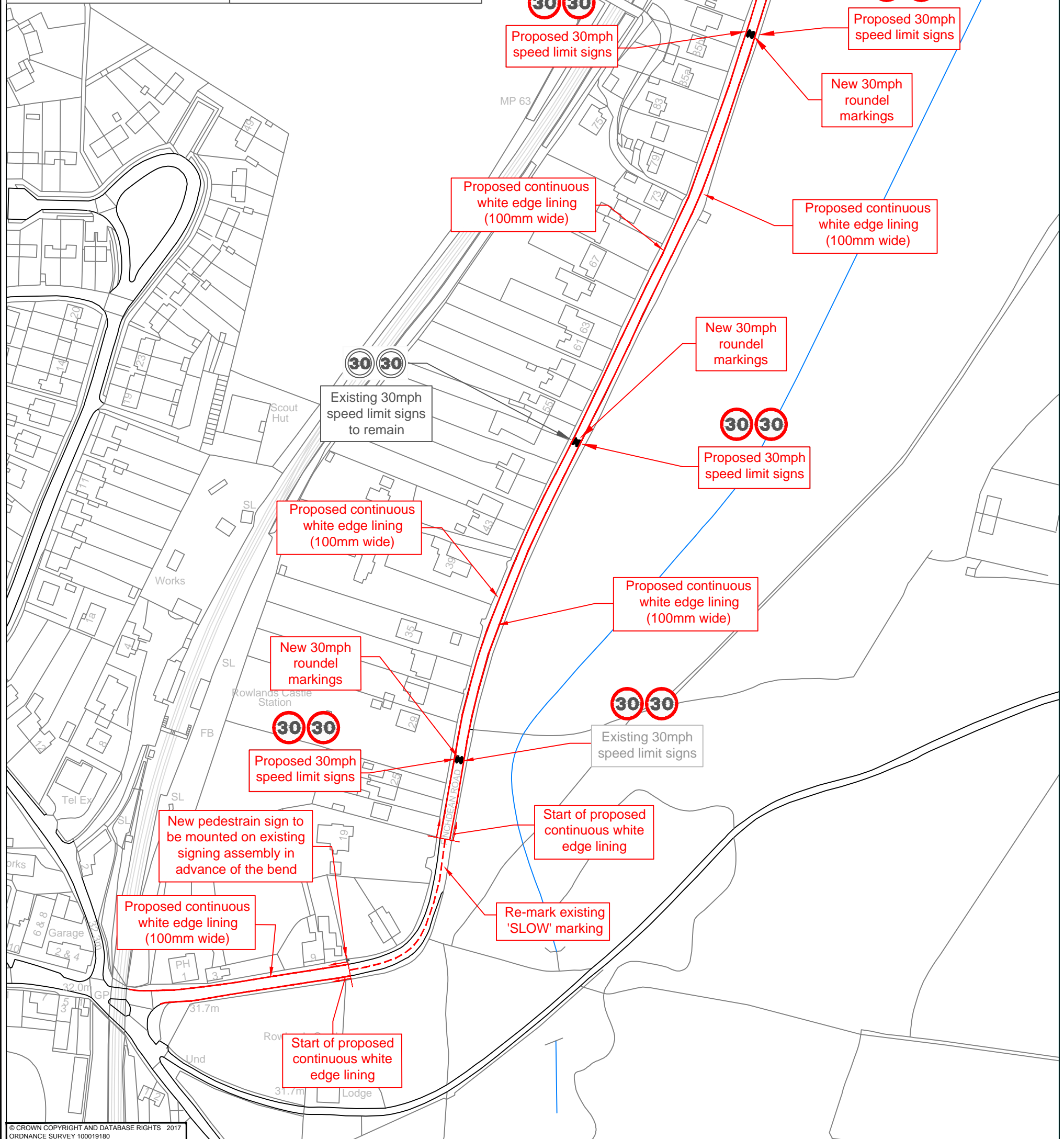

© CROWN COPYRIGHT AND DATABASE RIGHTS 2017
ORDNANCE SURVEY 100019180

<p>Hampshire County Council</p> <p>STUART JARVIS BSc DipTP FCIT MRTPI DIRECTOR OF ECONOMY, TRANSPORT & ENVIRONMENT</p>		DESIGNER AM	SCHEME FINCHDEAN ROAD ROWLANDS CASTLE	DRAWING TITLE CFI PROPOSALS PLAN FINCHDEAN ROAD	
		CAD AM		JOB No. SCALE @ A1 1:1000	DATE 14/03/18
REV	AMENDMENTS	DATE	CAD	CHKD	APPD

HCC CAD FILE: K:\Traffic Management Group\Lindsay-CAD\Drugs-Alistair\Rowlands Castle.dwg